

Key

- ① — Decaflex Top Coat applied in strict accordance with Sika Liquid Plastics Project Specification
- ② — Decaflex Embedment Coat applied at correct coverage rate for the substrate surface conditions embedded with Sika Reemat Premium GFM
- ③ — Sika Liquid Plastics Carrier Membrane SA applied in strict accordance with Sika Liquid Plastics Specification
- ④  Decotherm insulation bonded in strict accordance with Sika Liquid Plastics Project Specification
- ⑤ - - - - S-Vap 5000E SA self adhesive Vapour Control Layer [as required] applied to substrates prepared and primed with Sika Primer 600 in strict accordance with Sika Liquid Plastics Project specification
- ⑥ Existing substrate prepared in strict accordance with Sika Liquid Plastics Project Specification
- ⑦ Tanalised timber fillets [as required] and hard edges bonded with Decostik SP
- ⑧ Typical rainwater pipe assembly
- ⑨ Sika Liquid Plastics Horizontal Outlet [to suit 110mm or 75mm pipework] square to round spigot
- ⑩ Fully reinforced Decaflex Waterproofing System dressed as far into new Horizontal Outlets as practicable
NOTE: Outlet body primed with Sika Liquid Plastics Metal Primer prior to Decaflex Embedment Coat application
- ⑪ Outlet flange bonded to the existing substrate with Decostik SP cold fusion adhesive
- ⑫ Leaf Guard inserted into horizontal outlet following through-cure of the Waterproofing System
- ⑬ Waterproofing termination to parapet in strict accordance with an approved Sika Liquid Plastics method

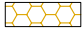
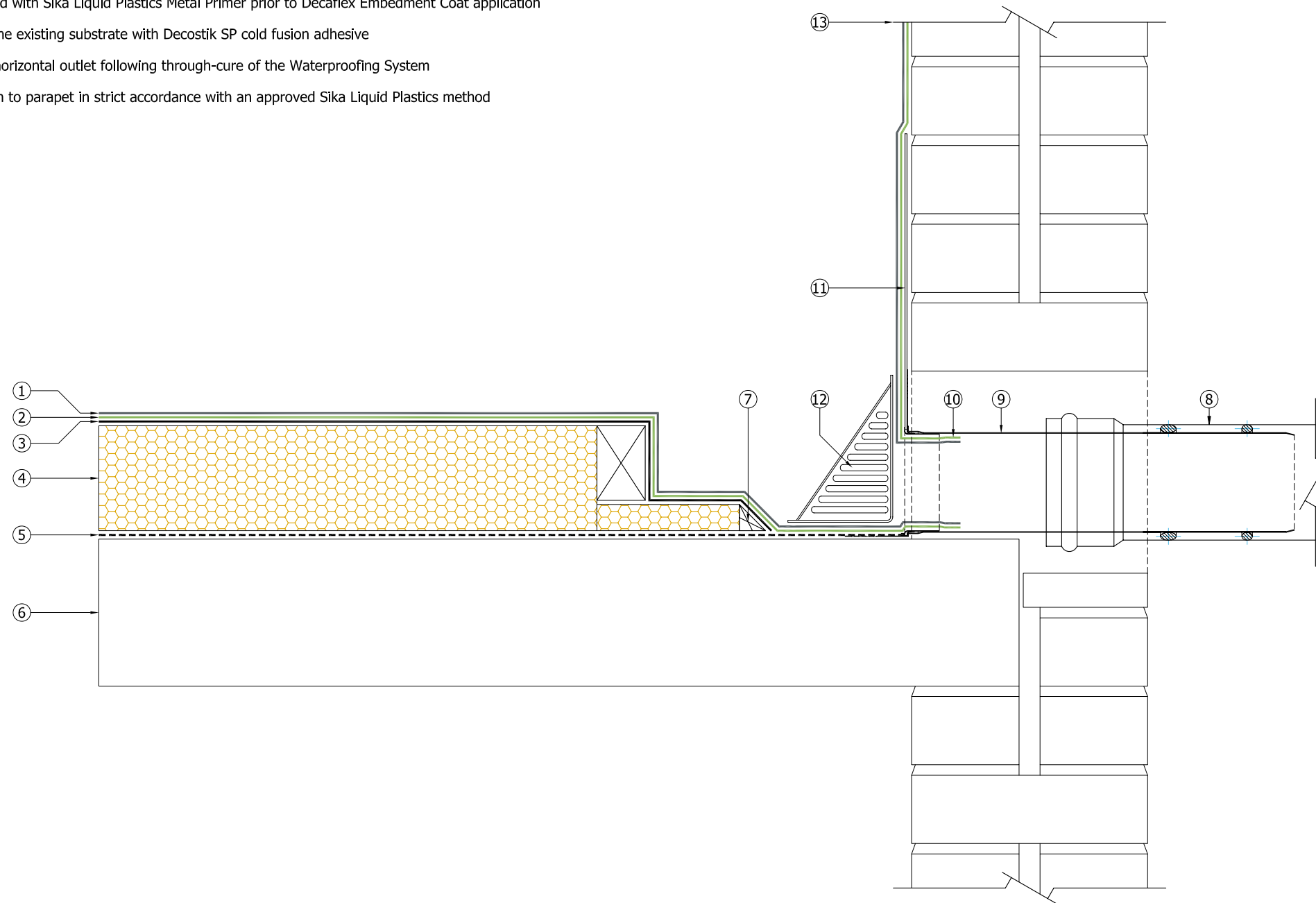

Sika Liquid Plastics
 Sika House
 Miller Street
 Preston
 Lancashire PR1 1EA
 Telephone: 01772 259781
 Email: technical.customer.services@uk.sika.com
 Web: www.liquidplastics.co.uk

This drawing is solely intended to illustrate the correct application of Sika Liquid Plastics products and systems, it must be read in conjunction with the appropriate specification and current issue of relevant Product Data Sheets. All elements bearing reference to structural and/or thermal design are shown indicatively and should not be used in whole or in part for any aspect of project design without consulting the relevant authorities.

For refurbishment projects, all aspects of the existing roof are deemed to be fully compliant with BS 6229:2003 [Code of Practice for Flat Roofs with Continuously Supported Coverings] or improved upon for instances where these standards are not met.

Site-specific details not covered by our standard range can be obtained by providing relevant information to the email address shown.

Project N ^o	
DWG N ^o	Revision
Project:	
Drawing Title: Built Up Roof Termination Detail to a Sika Liquid Plastics Horizontal Outlet [110mm and 75mm options]	
Scale: NTS @ A3	Drawn:
Date:	

